



# ABRASION-RESISTANT PIPELINES

EUTIT manufactures pipes fitted with abrasion-resistant and chemically-resistant lining from basalt or EUCOR.

The products are suitable for transporting highly abrasive materials and they are used to increase the lifespan of the pipeline in pneumatic and hydraulic transportation of materials.

The products are used in power plants, heating plants, mines and other heavy industrial operations.

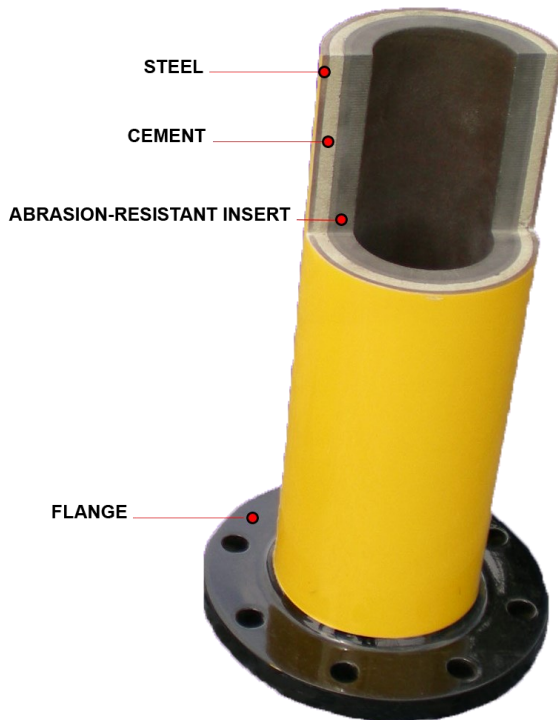

We also manufacture and deliver abrasion-resistant and chemically-resistant lining for the protection of other equipment, such as chutes, containers, discharge hoppers, chain conveyors, screw conveyors, cyclones, separators, exposed floor areas and other. The abrasion-resistant lining significantly extends the lifespan of equipment stressed by abrasion.

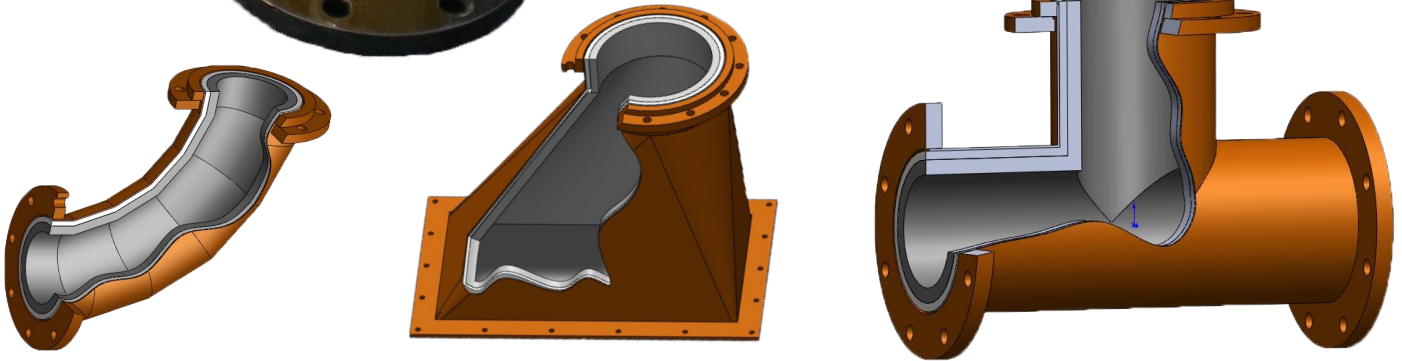

Examples of Abrasion-resistant Pieces with Basalt / EUCOR Lining



Examples of Abrasion-resistant Basalt and EUCOR Components

Abrasion-resistant pipelines lined with cast basalt or EUCOR are most often used for the pneumatic transportation of powder and fine-grained substrates with the maximum speed of 22 m/s for basalt and 30 m/s for EUCOR or for the hydraulic transportation of highly abrasive materials and sludge up to the speed of 2.2 m/s and maximum operating overpressure of 4 MPa. The lined tubes can also be used for tube chain conveyors, also for the transportation of hot substrates.

**EUTIT s.r.o.**, EUCOR and Basalt Casting Plant, Stará Voda 196, 353 01 Mariánské Lázně, CZ

Tel.: +420 354 789 114, 184, 141; Fax.: +420 354 691 480; e-mail: [eutit@eutit.cz](mailto:eutit@eutit.cz); [www.eutit.cz](http://www.eutit.cz)

TRADITIONAL CZECH MANUFACTURER SINCE 1951





# ABRASION-RESISTANT PIPELINES

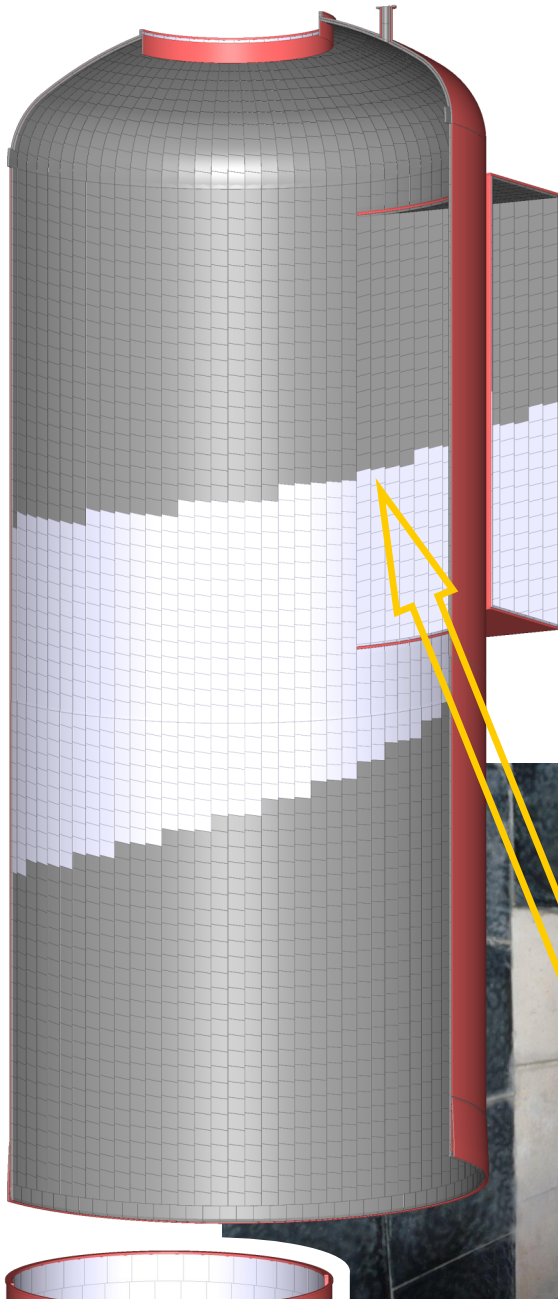

**EUTIT s.r.o.**, EUCOR and Basalt Casting Plant, Stará Voda 196, 353 01 Mariánské Lázně, CZ

Tel.: +420 354 789 114, 184, 141; Fax.: +420 354 691 480; e-mail: [eutit@eutit.cz](mailto:eutit@eutit.cz); [www.eutit.cz](http://www.eutit.cz)

TRADITIONAL CZECH MANUFACTURER SINCE 1951